

Integra's superior low-impedance stereo amplification and raft of integration features for dual-zone audio is now easier than ever to enjoy thanks to new streaming technologies supported over 5 GHz / 2.4 GHz Wi-Fi®, including Chromecast built-in, DTS Play-Fi®, AirPlay, and FlareConnect™ wireless multi-room audio distribution.

ADVANCED FEATURES

- Dual-band 5 GHz / 2.4 GHz Wi-Fi® Wireless LAN for Stable Connection with Enhanced Network Functionality
- Chromecast built-in Wireless Audio Platform and Google Assistant Voice Control Support
- DTS Play-Fi®** Multi-room Hi-Fi Music Streaming Capability
- AirPlay Audio Streaming from iTunes and iPad, iPhone, and iPod touch
- Spotify® Connect, TIDAL, TuneIn, Pandora®, and Deezer Services*2
- FlareConnect™ Multi-room Network and Analog*3 Wireless Audio Distribution
- Integra Control Pro Remote App for iOS and Android™ Devices*4 Enables Easy Initial Setup, Multi-room Management, and System Control
- Bluetooth® Wireless Technology Version 2.1 + EDR Capability (Compatible Profile: A2DP v1.2, AVRCP v1.3)
- Plays DSD Direct 5.6 MHz Stereo, 192 / 24 PCM, Dolby® TrueHD*5, FLAC, WAV, ALAC, AIFF, WMA Lossless, MP3, and AAC via Network and USB Input
- Supports Gapless Digital Audio Playback via USB Inputs and Network
- Speaker A / B Drive
- Direct Mode for Audio Reproduction Close to Original Source Quality

OTHER FEATURES

- 135 W/Ch at 6 Ω, 1 kHz, 1 Channel Driven of 1 % THD, IEC
- High-Performance AKM AK4452 762 kHz / 32-bit DAC
- Stable Drive for 4-Ohm Speakers
- Massive Customized High-output Power Transformer
- Two Custom-Made 8,200 μF low impedance Capacitors
- Fully Discrete Output Stage Circuitry
- Hand-selected Audio-tuned Parts to Ensure Low-Impedance Performance
- Audiophile Grade Anti-Resonant Aluminum Front Panel
- Anti-Vibration Oval Chassis
- 4 Digital Audio Inputs (2 Optical and 2 Coaxial, 192 kHz / 24-bit Capable)
- 6 Gold-plated Analog Audio Inputs (Excluding Phono Input) and 2 Outputs
- Main Zone Pre Out
- Gold-plated Phono Input (MM) for Turntable Connection
- Gold-Plated Quarter-inch Headphone Jack
- Transparent High-Grade Banana Plug-Compatible Speaker Terminals

- Front USB Input (500 mA / 1 V) fAudio Playback via USB Storage Devices
- Rear USB Input (1 A / 5 V) USB-HDD Audio Playback and to Power Media Streaming Dongles
- Auto Power On via Optical and Bluetooth When Signal is Detected
- High-Quality Gold-Plated RCA Terminals to Eliminate Surface Corrosion and Oxidation
- Independent Bass, Treble, and Balance Control
- 3-Mode Display Dimmer (Normal / Dim / Dimmer)
- 40 FM / AM Random Presets
- Direct-Access Tuning with 10 Key Buttons (via Remote Control)
- Preset Station Naming (Up to 10 Characters)
- Sleep Timer

CUSTOM INTEGRATION FEATURES

- Bi-directional IP and RS-232 Port for Advanced Home Automation Control Systems
- Zone 2 Pre- / Line Out for Distributed Audio Playback in Another Room
- Zone 2 DAC for SPDIF, NET and USB Sources
- Supports Metadata for Network / USB Audio Line Distribution in Zone 2
- Zone 2 Subwoofer Pre Out
- Independent Zone 2 Bass / Treble / Balance Control
- Dealer Settings Memory Store and Recall
- Remote Play Zone Function Enables Zone Selection for Audio Playback via Chromecast built-in, AirPlay, Spotify Connect, and DMR (Digital Media Render) Smartphone
- Front Panel Lock / Unlock Capability
- 2 IR Inputs and 1 Output
- 3 Programmable 12V Trigger Outputs with Adjustable Delay (A: 100 mA, B: 25 mA, C: 25 mA)
- Reset Function, Firmware Updates, and Temperature Based Fan Control via 3rd Party Control Systems
- Firmware Updates via ISCP for Dealers and Installers
- Optional Rack-Mount Kit Available (IRK-130-3B)

*1 Requires firmware update. *2 Availability of services may vary with region. Please confirm before purchase. Subscription may also be required. *3 Sharing audio from external analog inputs is enabled with a future firmware update. *4 For iOS and Android devices. Please check App Store or Google Play for device and OS requirements. *5 Dolby TrueHD playback via USB input only.

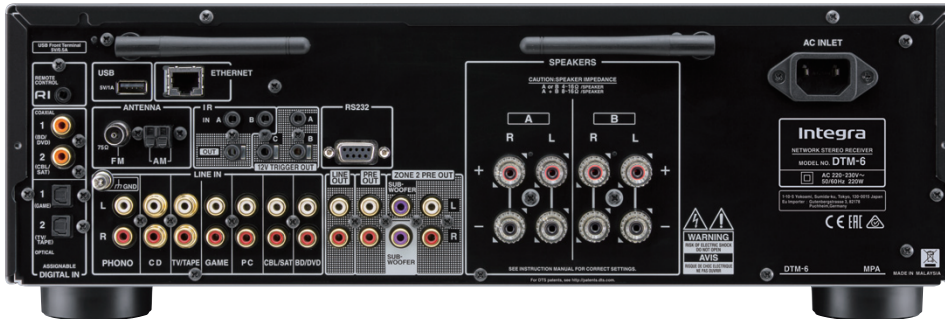

SPECIFICATIONS

AMPLIFIER SECTION

Power Output	
All Channels :	135 W/Ch at 6 Ω, 1 kHz, 1 Channel Driven of 1 % THD, IEC
Dynamic Power :	180 W (3 Ω, Front) 160 W (4 Ω, Front) 100 W (8 Ω, Front)
THD+N (Total Harmonic Distortion + Noise) :	0.08% (20 Hz–20 kHz, Half Power)
Input Sensitivity and Impedance :	200 mV / 50 kΩ (Line) 2.5 mV / 50 kΩ (Phono MM)
Rated RCA Output Level and Impedance :	150 mV / 470 Ω (Pre Out) 470 mV / 680 Ω (Subwoofer Pre Out) 200 mV / 2.2 kΩ (Zone2 Pre / Line Out) 150 mV / 2.2 kΩ (Zone Pre Out)
Phono Overload :	70 mV (MM 1 kHz 0.5%)
Frequency Response :	10 Hz–100 kHz / +1 dB, -3 dB (Direct Mode)
Tone Control :	±10 dB, 100 Hz (Bass) ±10 dB, 10 kHz (Treble)
Signal-to-Noise Ratio :	106 dB (Line, IHF-A) 80 dB (Phono MM, IHF-A)
Speaker Impedance :	4 Ω–16 Ω (Speaker A or B) 8 Ω–16 Ω (Speaker A + B)
Headphone Output Impedance :	390 Ω
Headphone Rated Output :	200 mW (32 Ω 1 kHz 10% THD)

TUNER SECTION

Tuning Frequency Range :	FM 87.5 MHz–108.0 MHz AM 520 / 530 kHz–1,611 / 1,710 kHz
FM / AM Preset Memory :	40 stations

GENERAL

Power Supply :	AC 220–230 V~, 50 / 60 Hz
Power Consumption :	220 W
Standby Power Consumption :	0.1 W
No-Sound Power Consumption :	65 W
Network Standby Power Consumption :	2.9 W
Dimensions (W x H x D) :	435 x 149 x 329 mm
Weight :	8.5 kg

CARTON

Dimensions (W x H x D) :	572 x 264 x 419 mm
Weight :	11.0 kg

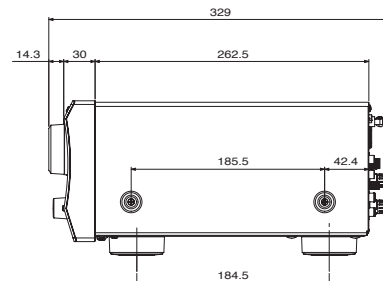
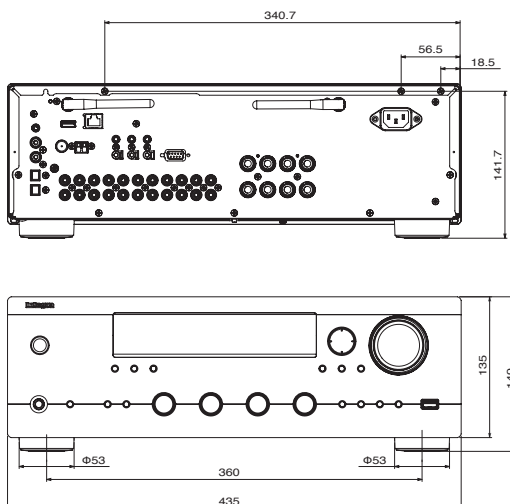

Due to a policy of continuous product improvement, Integra reserves the right to change specifications and appearance without notice. For DTS patents, see <http://patents.dts.com>. Manufactured under license from DTS, Inc. DTS, Play-Fi, the Symbol, and Play-Fi together in combination with the Symbol are trademarks of DTS, Inc. DTS and Play-Fi are registered trademarks of DTS, Inc. © DTS, Inc. All Rights Reserved. The Bluetooth® word mark and logos are owned by the Bluetooth SIG, Inc. AirPlay, iPad, iPhone, iPod, iPod touch, iTunes, and Mac are trademarks of Apple Inc., registered in the U.S. and other countries. App store is a service mark of Apple Inc. "Made for iPod" and "Made for iPhone" and "Made for iPad" mean that an electronic accessory has been designed to connect specifically to iPod, iPhone, or iPad, respectively, and has been certified by the developer to meet Apple performance standards. Apple is not responsible for the operation of this device or its compliance with safety and regulatory standards. Please note that the use of this accessory with iPod, iPhone or iPad may affect wireless performance. AirPlay works with iPhone, iPad, and iPod touch with iOS 4.3.3 or later, Mac with OS X Mountain Lion or later, and PC with iTunes 10.2.2 or later. Android, Google Play, and Chromecast built-in are trademarks of Google Inc. Wi-Fi® is a registered trademark of the Wi-Fi Alliance. The Wi-Fi CERTIFIED Logo is a certification mark of the Wi-Fi Alliance. Spotify and the Spotify logo are trademarks of the Spotify Group, registered in the U.S. and other countries. DSD and the Direct Stream Digital logo are trademarks of Sony Corporation. FlareConnect, Integra Control Pro is a trademark of Onkyo Corporation. All other trademarks and registered trademarks are the property of their respective holders.